

9 October 2024

PETERBOROUGH COURT

NLA RETROFIT SUMMIT



John A. Peterborough Architects

JRA

Fleet Street

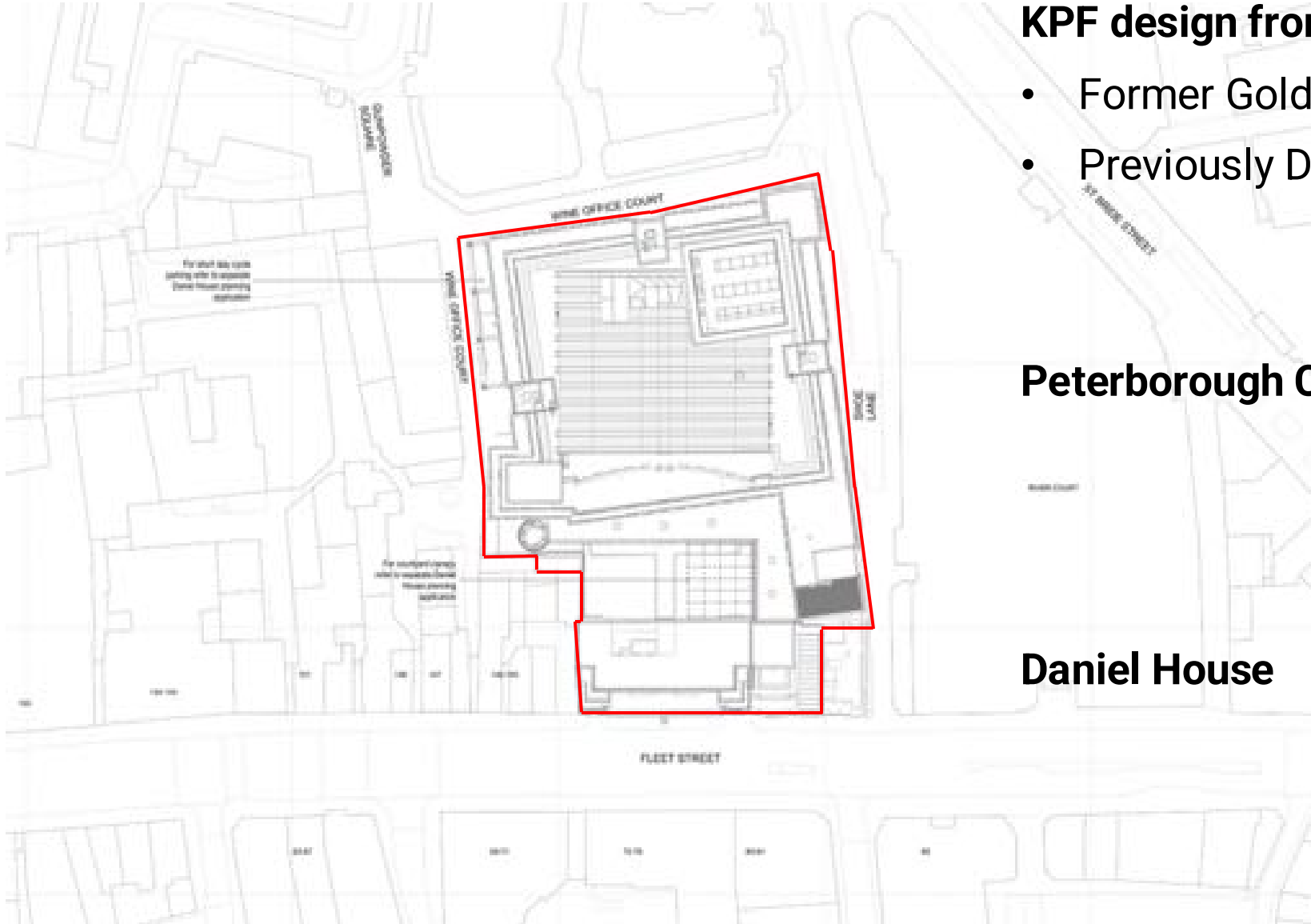

KPF design from 1989

- Former Goldman Sachs headquarters
- Previously Daily Telegraph headquarters

Peterborough Court

Office 25,019m² NIA

Retail 540m² NIA

Daniel House

Office 3,103m² NIA

Retail 996m² NIA

Ground Floor Plan

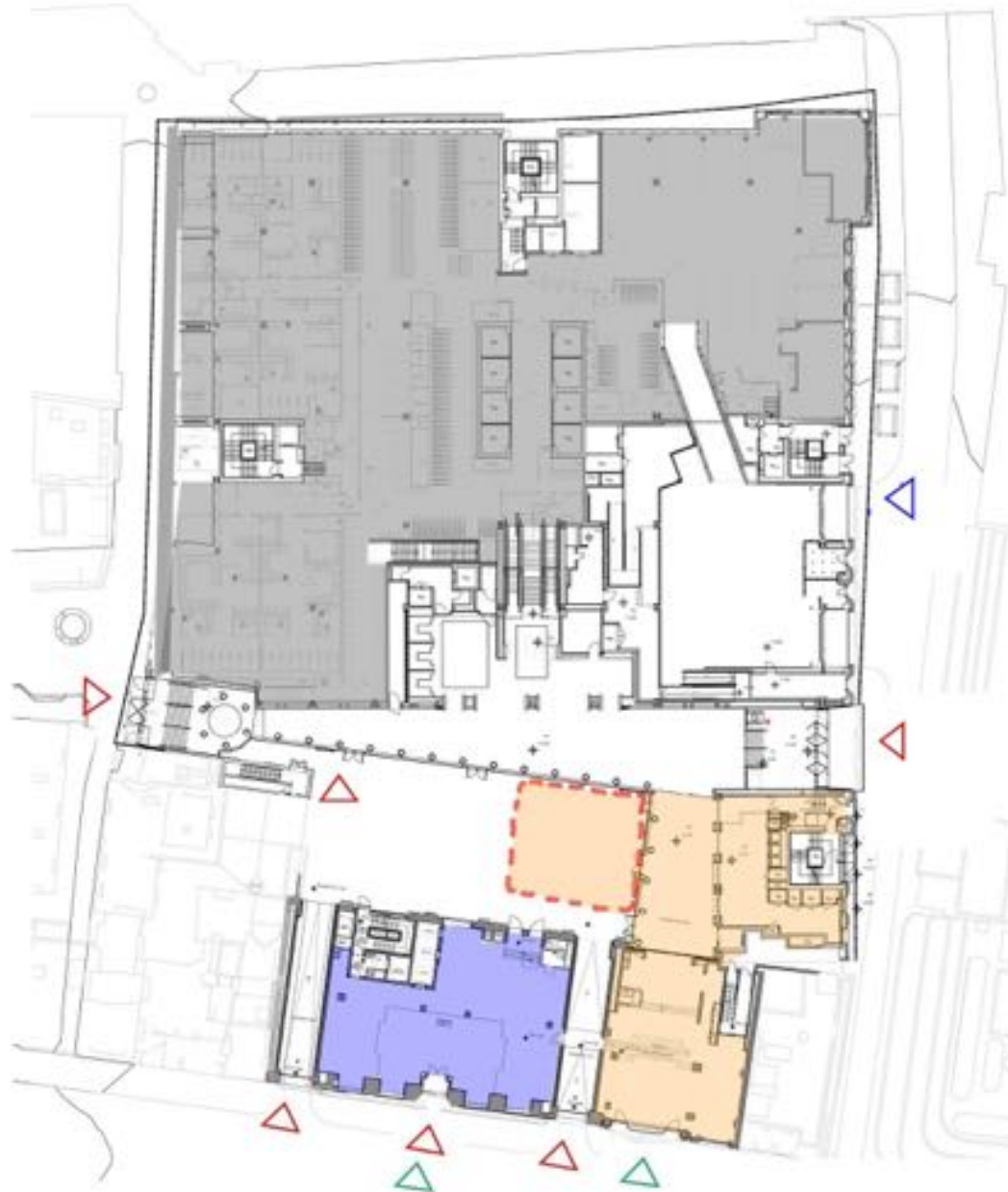

- △ Retail / restaurant entrance
- △ Office entrance
- △ Servicing entrance

Shoe Lane Entrance



Wine Office Court Entrance



Courtyard view looking North East



Courtyard view looking North West



Long Gallery internal view looking towards Wine Office Court Entrance



Long Gallery internal view looking towards Shoe Lane Entrance



View of reception area



View of library area



Amenity Overview



Basement Level 2: Auditorium and Gym



Basement town hall auditorium view



Basement gym view



Cycle Villages



Peterborough Court

450 cycle spaces

3 'villages' with:

46 showers

480 lockers

6 drying rooms

Daniel House

84 cycle spaces

8 showers

84 lockers

Basement End of Journey changing facilities village view



Birds eye view of development



Credentials

Sustainability, connectivity and wellbeing to rival new build

BREEAM Excellent Targeted

BCO Compliant (2019)

WELL Platinum 'enabled'

EPC 'B'

All electric building

WiredScore Platinum targeted

ActiveScore Platinum targeted

