



Open Call Hope in the Square



Peckham Square, Southwark Council

1

The commission

Southwark Council are seeking to commission a creative or creative team to design and deliver a green space that celebrates youth, as part of the re-development of Peckham Square. NLA have been commissioned to run a design competition to find the creative or creative team to deliver the project. The key objective of this competition is to create a unique meeting place for young people and local communities to gather and reflect, take a positive look towards the future and honour Peckham's past to build on Damilola Taylor's legacy and the work of his family as well as the Hope Collective.

We are inviting architects, designers, artists and other creatives to submit design concepts that will reimagine and develop this garden-like area of the square into a safe, accessible and inclusive space. The designs should improve facilities for all users while strengthening connections with the surrounding neighbourhood. This opportunity therefore seeks to improve this important local asset and the experience it offers to its residents and visitors.

Damilola Taylor's legacy and the work of his family and the Hope Collective sits at the heart of this project and strong collaboration with Southwark Council, Damilola

Taylor Trust (DTT) and Hope Collective on addressing local identity will be essential to its success.

A temporary exhibition of shortlisted entries will be on public display with an opportunity for people to register comments and feedback. The intention is that following a two-stage competition judging process and public engagement on submitted proposals, the winning team will be revealed in Autumn 2025 and, subject to procurement and governance procedures, will be awarded a budget of up to £100,000 + VAT to consult on, develop and deliver a fully costed, feasible design, to be installed over the coming year.

2

Context

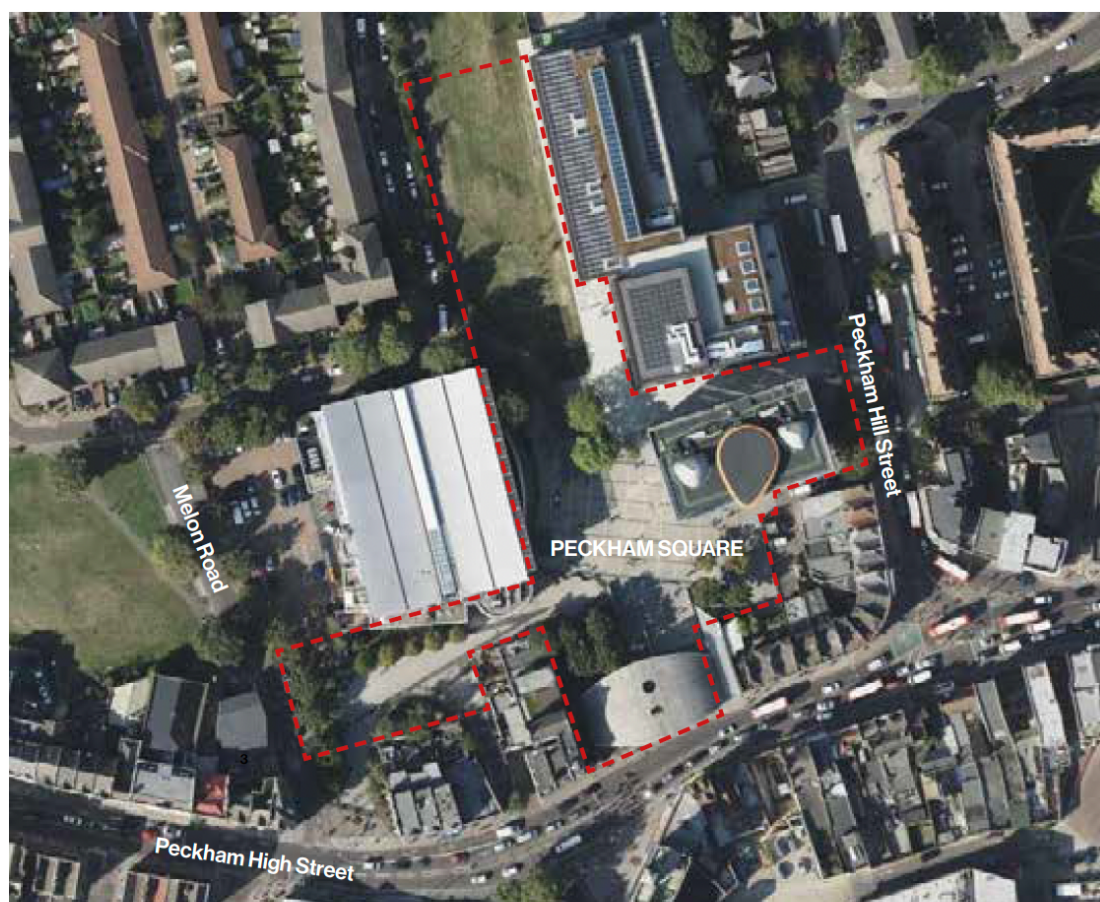

Peckham Square

Peckham Square was planned in the early 1990s as the centrepiece of a Southwark Council-led regeneration programme. Now approaching 30 years old, the square is showing some signs of wear and tear, while patterns of usage and the complex roles of public space have also changed.

In response to this, Southwark Council wish to revitalise the space, ensuring it continues to act as a focus for the community in the years ahead. Graeme Massie

Architects and Scott Whitby Studio are collaborating with Southwark Council on the upgrades, with the detailed proposal expected to go to Planning in the summer of 2025.

The redevelopment of Peckham Square is one of Southwark Stands Together flagship projects and the Council has allocated an overall budget of more than £7m to the delivery of this scheme in two phases.

The first phase includes the restoration and repurposing of the Victorian terraced buildings at 91-93 Peckham High Street, providing a new home to Peckham Platform, a local educational arts charity previously based in the square which provides cultural experiences targeted at our diverse communities.

The second phase comprises the refurbishment of the wider Peckham Square, including improvements to hard landscaping, installing additional lighting and CCTV to address localised anti-social behaviour. Further to this, there will be additional greening, the restoration of existing public artwork such as the Peckham Peace Wall, and opportunities for additional art installations such as what is sought after through this brief.

A series of consultation events, including a 10-day long exhibition in Peckham Library and an online survey were arranged during January-February 2025. This has allowed the community to leave feedback and answer questions about the proposed new designs.

There have been more than 200 drop-in visitors and consultation responses and the overall feedback from the public has been very positive. This support was even more evident when specifically discussing the possibility of creating a meeting place to celebrate youth, and honour Damilola Taylor's legacy.

Young people, safety and the public realm

The Damilola Taylor Trust, established in May 2021 in memory of Damilola Taylor, who tragically lost his life in Peckham on 27 November 2000, advocates for the safety and well-being of young people facing adversity.

Damilola's father, Richard Taylor OBE, set up the Trust as a memorial to his son with the aim of providing a legacy of hope and opportunity for disadvantaged and under privileged young people. Richard Taylor sadly passed away on the 23 March 2024.

The Trust's mission is to create a future where all young people can live free from violence and fear, with the chance to fulfil their potential and face the future with confidence and optimism. This commission aims to honour not only the memory of Damilola and other young victims but also to highlight the hopes, dreams, and

aspirations of young people today, offering a platform for their voices and focusing on creating positive change for the future.

Day of Hope

December 7th, Damilola's birthday, was officially designated as the Day of Hope by Prime Minister Boris Johnson on the 20th anniversary of Damilola's killing in 2020.

The 2025 Day of Hope will be a focal point of the 25th anniversary of Damilola's killing, celebrating his legacy and an opportunity for the winning design team of this competition to unveil their final designs to the public.

3

Site

Peckham Square Redevelopment Masterplan

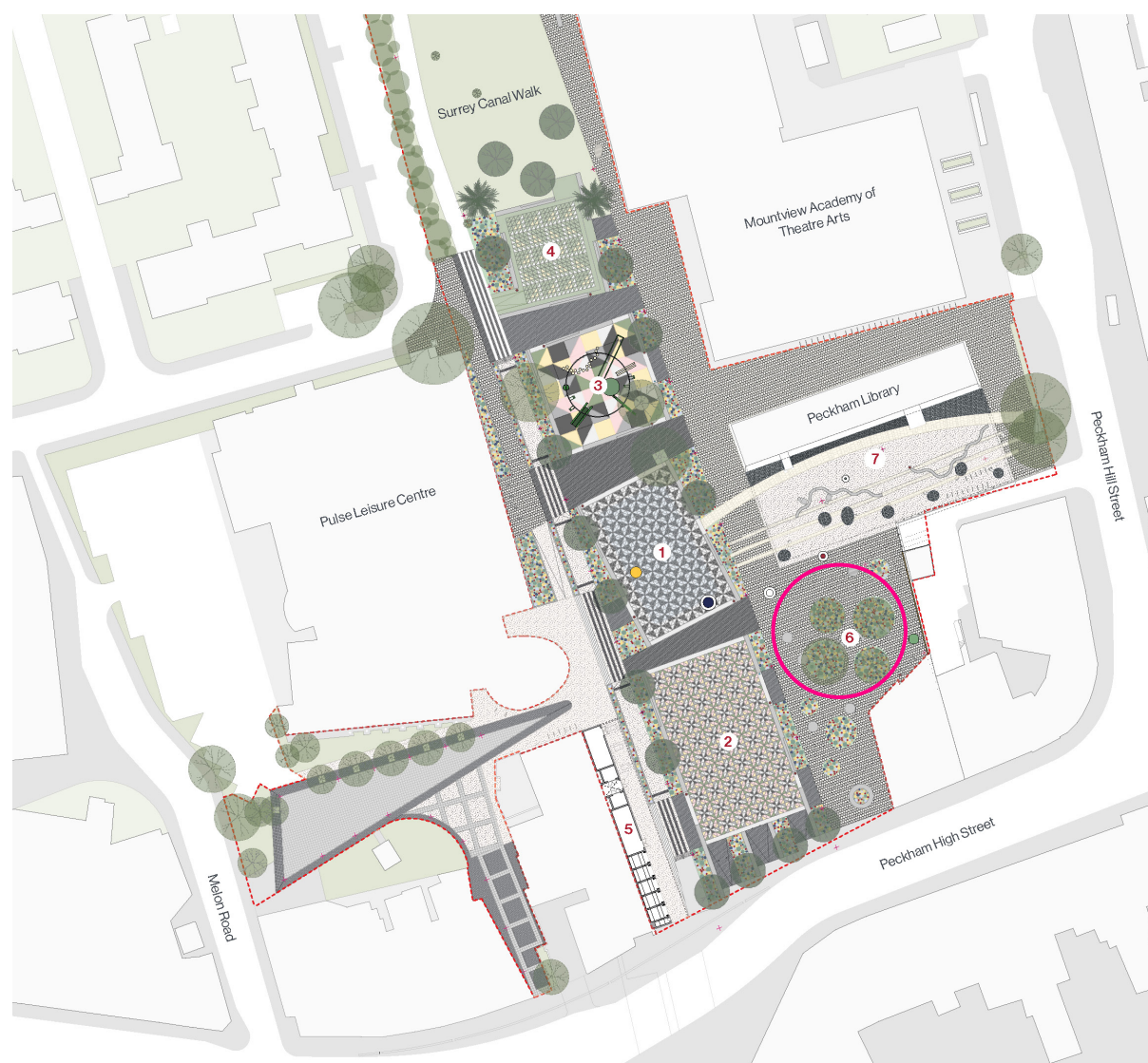

Project location, Peckham Square Redevelopment Masterplan by Graeme Massie Architects and Scott Whitby Studio

Key Spaces:

- 1 Fountains / Water / Events
- 2 Markets
- 3 Play
- 4 Performance
- 5 Pavilion
- 6 'Garden' zone**
- 7 Library landscaping

Peckham Square Redevelopment



Peckham Square Redevelopment Proposal by Graeme Massie Architects and Scott Whitby Studio

Competition Project site: 'Garden' zone



Vision for the 'Garden' zone at Peckham Square (RIBA Stage 3) by Graeme Massie Architects and Scott Whitby Studio

This design competition seeks a creative or creative team to reimagine and develop the ‘Garden’ space as part of the Peckham Square redevelopment. The space will serve to connect people between Peckham Library and the new home of Peckham Platform.

As a central feature of the masterplan, this space presents a unique opportunity to create a design that reflects the hopes of young people and responds meaningfully to the voices of the local community.

The visual above shows an early design concept by Graeme Massie Architects and Scott Whitby Studio. While the four existing trees must be retained and integrated into your proposal, the remainder of this area is open for reinterpretation. The exact project boundary will be shared with shortlisted teams in Round 2.

Existing Public Art

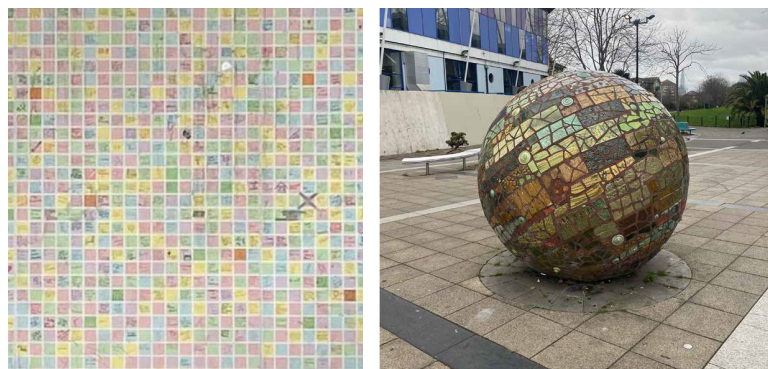

Peckham Peace Wall (left), The Elements (right)

This commission will sit in the wider context of a range of artworks which currently exist across the square.

It is anticipated that each artwork will require some level of repair and refurbishment but propose that the pieces are retained and relocated to ensure their continued contribution to the square. These existing artworks include *Peckham Peace Wall* by Garudio Studiage and *The Elements* by Duncan Hooson.

Paving

As part of the wider works new paving is being designed across the whole square. Graphic patterns are being developed through co-design workshops with local young people through the first half of 2025. The winning team of this competition will have the opportunity to collaborate with the Peckham Square design team to ensure the ‘garden’ zone and proposed paving form a cohesive and integrated landscape.

Design Requirements

The competition seeks a creative design solution for a dynamic and vibrant response that will not only invite engagement from local communities and contribute visually to Peckham Square but will celebrate the voices of young people and honour Peckham's past to build on Damilola Taylor's legacy and the work of his family and the Hope Collective.

Overall, the key objectives of the project are to deliver a green space that:

- Is visually striking and engaging
- Responds to the immediate surroundings and neighbourhood area
- Is inclusive and welcoming to young people, families and individuals of all ages
- Is representative of local communities, reflecting the cultural heritage – past, present and future – of the area and people living around
- Is informed by the voices and perspectives of local youth groups
- Exemplifies an inclusive approach to the built environment and public art in line with Southwark Stands Together commitments

The winning scheme may include – but is by no means limited to – the following components:

- Sculptural elements or other forms of public art
- Seating
- Greening and soft planting
- Pavement treatments
- Lighting installations

Further guidance:

- This feature will be a permanent part of the Peckham Square upgrades. It is expected to be in place for a minimum of 15 – 20 years
- Any winning design need be robust enough to withstand all weather conditions
- Designs should also consider sustainability and require minimal maintenance
- Where possible the final installation should be able to be constructed or assembled in situ
- Local community engagement is critical to the success of the work. Shortlisted applicants will have an opportunity to meet local residents, traders and/or other stakeholders during a guided site tour and public exhibition
- The selected design will be subject to planning permission and approval, and will need to address the design's context within the wider masterplan
- Following the award of contract to the winning team, it will be expected that the selected team engages extensively with the local community in developing their design ideas and finalising the design. The judges invite

design teams to consider how the local community could be involved in the construction and/or installation of their proposal.

5

Budget

The total budget available for this project is up to £100,000 + VAT. This needs to include all fees, fabrication, installation, other capital costs and contingency. Minimum contingency within the budget should be 10%, although we recommend allocating 15% contingency in your stage 2 submission, if shortlisted.

The fabrication and installation of the winning design will be subject to a separate tender exercise in line with the procurement rules of the Southwark Council.

The budget outlined includes a 12.5% design fee, of up to £12,500 for the appointed team to cover on-going design fees and other costs required to deliver the concept. If your practice is not VAT registered, you will need to consider this when preparing your budget.

The winning team will be expected to undertake the following tasks:

- To work with Southwark Council and the Peckham Square design team to develop a fully costed, feasible design that can be installed with the delivery of Peckham Square in 2026
- Undertake community engagement
- Project management, design supervisory role during the construction of winning design

6

Submissions requirements

This competition has a two-stage competition.

This first stage submission should be single PDF submission of no more than 10-pages and maximum 5MB and include the information below. Alternatively, you can submit your application in another format (e.g. video) but the content should not exceed the equivalent of a '10-page limit'.

Your submission should include the following:

Your experience:

- Brief biographies of all the project team.
- A 200-word description about your practice along with any relevant technical and consultation experience acquired through previous projects.
- A selection of relevant previous work, including images.

Your response to the brief. Please provide reflections on the following prompts:

- The overall design brief - why you are interested in being involved in the project?
- Your initial vision for the project.
- How would you engage local young people to develop your design, if selected?

You can submit your response to these prompts in any format. For guidance, this should be (equivalent to) a short paragraph of max. 300 words per prompt or 90 second video per prompt.

No design work is required for the first stage.

Shortlisting

Submissions will be shortlisted by the judging panel. Up to six shortlisted practices will then be invited to develop a design concept based on the information laid out in this open call and will be awarded an honorarium of £1,500 + VAT each. The work required for the second phase of the project will be reflective of the honorarium sum.

At shortlisting, the second stage submission should include:

- 2 x Boards which present your design to a public audience for consultation. Templates to be provided by the organiser if shortlisted.
- Maximum 10-page PDF explaining your proposal to be shared with the jury for review, prior to interview. Your submission should include:
 - Detailed design drawings (we accept a variety of formats including hand or computer drawn 3D design visualisation)
 - Key construction details drawn to scale, with key dimensions noted
 - Outline budget*
 - Draft Risk Assessment
 - Maintenance Plan
 - Fabrication process
 - Structure of your creative team for delivery
- PowerPoint presentation for the purposes of judging.

*If your practice is not VAT registered, you will need to consider this when preparing your budget.

Submission information

For any questions about the competition or submission process, please email:

lucy.millichamp@nla.london

7

Eligibility

The competition is open to architects, designers, artists, landscape architects and other creatives. We welcome collaborations; however, the project team must include a qualified architect or landscape architect if selected as the winning team.

We are interested in seeing applicants from local organisations or those who are collaborating with local groups.

We actively encourage applications from people of all backgrounds, especially those currently less represented in the creative sector. We welcome collaborative approaches and invite applications from consortia. Selecting a practice or collaboration that operate as SME's or as Black, Asian and minority ethnic-led are a priority to Southwark Council in light of their borough-wide initiative Southwark Stands Together (SST).

If you are interested in forming a team or collaboration for this submission but don't already have the connections you need, there may be an opportunity to connect with other creatives through our event on site in Peckham Square on Wednesday 25th June 5-7pm, you can RSVP [here](#). This is also an opportunity to learn more about the site, the competition and meet the commissioning team.

8

Deadline and submission details

- Deadline for first submission is Midday Thursday 14th August.
- Submissions received after time this will not be considered.
- For competition enquires please contact: lucy.millichamp@nla.london
- We are using zealous.co to administrate our application process. To submit your expression of interest for this competition, you will need to set up a free login on zealous which will enable you to begin your submission as a Draft and save it as you go. You can find information about [how to submit via zealous here](#).
- To submit your entry please go [here](#).

9

Schedule outline

Submissions open: Thursday 12th June, 12:00

London Festival of Architecture Event: Wednesday 25th June, 5-7pm (RSVP [here](#))

Round 1 Submissions closed: Thursday 14th August, 12:00

Successful shortlisted teams notified: w/c 1st September

Site visit with shortlisted teams: w/c 8th September

Round 2 submission deadline: 12:00, Thursday 9th October

Public Exhibition of shortlisted designs: w/c 20th October

Final judging / interviews: w/c 27th October

Winner notified: w/c 27th October

Day of Hope: 7th December

10

Judging panel

The judging panel will be made up of a number of experts and local representatives and will be announced before the round one submission deadline.

NLA Chair – Rosa Rogina, Director, London Festival of Architecture

11

Judging criteria

Round 1 Judging Criteria

- **Practice/team profile (60%)** Does the team have skilled professionals for delivering the proposal in line with eligibility outlined in the Open Call? Does the team have a diverse set of skills and experience? Are the previous work experiences and/or their work methodologies and wider design aspirations relevant to the competition? Does the team proposed align with the eligibility criteria stated in the brief?
- **Initial vision/response to the brief (40%)** Does the proposal's initial written reflection to the brief suggest innovation, surprise and creativity? Does it explore a new and original way to use and engage with the area? Is the team thinking beyond possible barriers or restrictions, and pondering how they might be broken down? Is the vision something which could be developed into an appropriate and achievable scheme for the area, in line with the brief?

Round 2 Judging Criteria

- Overall Design (30%)
- Costs and Feasibility (25%)
- Safety and Equity (15%)
- Sustainability and Longevity (15%)
- Contextual Design and Public Engagement (15%)

12

Access

Accessibility, diversity and inclusion are core values of the LFA at all levels of our organisation, and we are committed to delivering projects that are representative of

the whole city and can be enjoyed by everyone. At the same time, we recognise that there are still significant barriers for groups in our society to be able to enjoy and participate in festival activity.

We will support with any resources and adjustments for anyone who needs it, to make applying for this role easier e.g. alternative document formats, interpreters, hybrid meetings. In the application form you will be asked how we can support you throughout the process; this will not influence your application.

www.londonfestivalofarchitecture.org/access/

13

Further information

- Submissions will be judged on originality, demonstration of creativity, relevance to the brief as well as feasibility and how the proposal works in the context of the site.
- To process entries to this competition we will share your application, and any associated personal data provided on the application with our jury and competition partners.
- All applicants will be notified of the outcome of their application, but due to the volume of submissions we may not be able to provide feedback to entrants individually.
- Applicants may not be assisted in any way in their submission by members of the judging panel, the client body, organisers, members of their family, close business associates or employees.
- The ownership of Copyright of the design will be in accordance with the Copyright, Designs and Patents Act 1988, that is Copyright rests with the author of the submitted design.
- All designs remain the intellectual property of the designer however the winning design will itself when built will be the property of Southwark Council.
- Please bear in mind the project requires a fast turn around and may have peak moments when your practice will need to dedicate sufficient staff to deliver the project on time, to budget and to the high standard expected by all stakeholders.
- If your practice/collaboration is appointed to deliver the project it will need to have the following insurance: Employers Liability, Professional Indemnity, Public Liability.
- Significant efforts are made by all stakeholders of the project to ensure wide media coverage.
- NLA reserve the right to use images from the submissions for promotional purposes in press, social media and publications. All endeavours will be made to ensure accurate accreditation.

14

Useful links

NLA:

www.nla.london

London Festival of Architecture:

www.londonfestivalofarchitecture.org

Southwark Council:

www.southwark.gov.uk

[Southwark's Public Art Policy](#)

[Southwark Stands Together Pledges](#)

Damilola Taylor Trust:

<https://www.damilolataylortrust.co.uk/>

Hope Collective:

<https://www.hopecollectiveuk.org/>

15

Contact

To submit your entry please go [here](#).

For general enquires please contact: info@nla.london

16

Disclaimer

The competition organisers are not liable for lost, misdirected, or late entries. Decisions of the jury represent their professional judgments and all decisions are final. While it is the intent to construct the winning scheme, the organisers reserve the right to not proceed with construction for any reason. Material submitted by you shall be your sole responsibility, shall not infringe or violate the rights of any other party or violate any laws, contribute to or encourage infringing or otherwise unlawful conduct, or otherwise be obscene, objectionable, or in poor taste. By submitting such material, you are representing that you are the owner of such material and/or have all necessary rights, licenses, and authorization to distribute it.

Commissioning organisations



NLA

NLA is London's built environment community, a cross-sector membership organisation for everyone committed to shaping a better city. Our 30,000+ members work across all aspects of city governance, planning, design, development, and management, spanning public and private sectors. Guided by the New London Agenda - our best practice framework for city-making - we come together year-round to develop new collective solutions for London: forming new ideas and partnerships, enhancing lifelong skills, and empowering a more diverse workforce. Our work has global relevance and is shared with cities worldwide.

nla.london

Instagram: [@nlalondon](https://www.instagram.com/nlalondon)

X: [@nlalondon](https://twitter.com/nlalondon)

LinkedIn: [@NLA](https://www.linkedin.com/company/nla)



Southwark Council

www.southwark.gov.uk

X: [@lb_southwark](https://twitter.com/lb_southwark)