

WE GROW HERE

Studio Bristow

BOLD
TENDENCIES



Together, we grow here

Our plan for the square is a striking, plant-driven design that celebrates the energy and vitality of Peckham’s youth, while providing 30+ new trees and re-using large amounts of site-reclaimed materials. With 10 new sculptures by local young people, it will be a lasting and fitting tribute to Damilola Taylor’s memory.

- We feel strongly that Peckham Square needs:
1. more greening (trees & plants)
 2. to be visually striking!
 3. to be an informal but enticing gathering place

1- Greening means softness, less noise, and more colour & movement. The immediate surroundings are pretty ‘hard’. Being amongst trees & other plants has been proven to reduces stress and improve our moods. We’re even proposing many pleached Lime trees that contain calming compounds in their sweet-smelling flowers!

2 -Visually striking because sits at the base of the dramatic Library and will have lots of other strong design to play off in the rejuvenated square. We believe we can do this almost entirely by plants alone!

3 – It’s currently a transitional space which doesn’t invite pausing/gathering. As well as the tree-given shelter, we want to add a clutch of new ‘boulders’, formed from the site rubble, to function as informal seating and play opportunities.

A nucleus of very tall, ultra-thin trees of various forms reach skyward, referencing Peckham’s pluralistic, vibrant community. Around these, curving ellipses of pleached Lime trees (like a curved hedge on stilts) form a ‘hug’ around the vertical forms. The sculptures’ designs are to be decided by Peckham’s youth, mentored by an established local artist. The only stipulation being they should be tall, thin and live happily here for decades to come!

Dan, our lead designer, moved to Peckham in the months after Damilola’s passing, and spent 15 years witnessing its creative flourishing. He started his landscape design journey here and has projects dotted through the area, including the Derek Jarman Garden for Peckham up on the roof at Bold Tendencies.

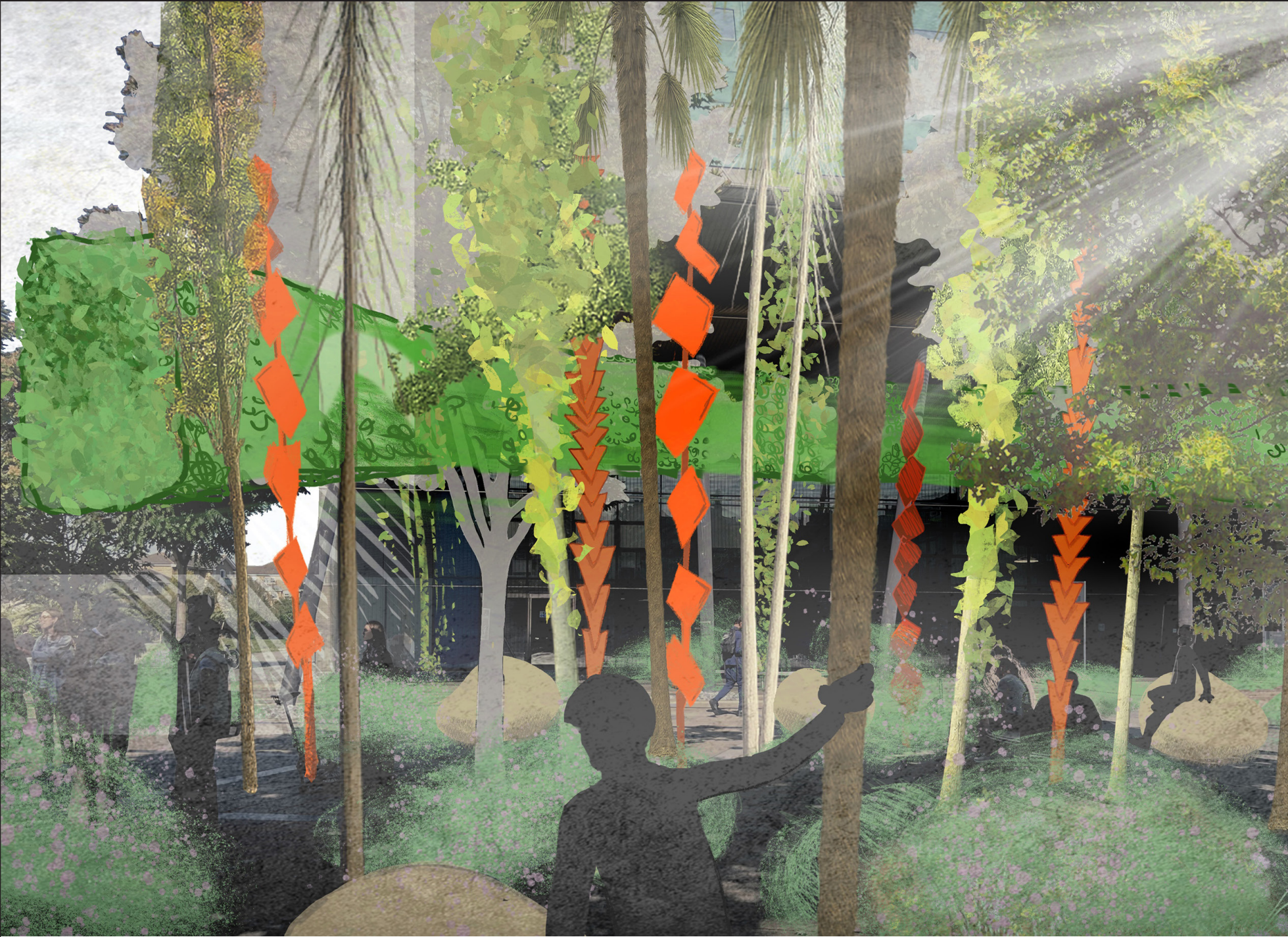

IN COLLABORATION WITH

- Bold Tendencies
- Artist TBC

A striking, green, and welcoming space created by and for the community for generations to come —featuring 30+ trees, 10 youth-designed sculptures, and extensive reuse of existing site materials.